

25 BEAUTIFUL HOMES

DREAMS FULFILLED

Striking self-build | Updated vicarage | Stylish lakeside retreat

MAKE IT YOURS
Smart decorating ideas for every room

EXPERT ADVICE
How to display art
Restoring period features
Adding a rustic touch

NEW LOOKS
Shopping for pretty pastels and romantic florals

CLEVER CONVERSION
'From two flats to one family home'



April 2017



20

INSPIRING HOMES

- 26 **HEAVENLY TRANSFORMATION** An old listed vicarage in Oxfordshire ripe for renovation proved a godsend for this couple
- 31 **SIMPLY DIVINE** Key pieces shine inside an understated townhouse in south London
- 37 **ARTISTIC LICENCE** Having an interior designer neighbour had its benefits for the owners of this beautifully revamped London cottage
- 53 **SMALL BUT PERFECTLY FORMED** This family liked their new-look holiday home in Sussex so much they opted to live there full-time
- 62 **NATURAL FLOW** A bright and spacious rear extension created a fun and functional

- 66 layout in this young family's home in Hove
- HOME FROM HOME** Creature comforts and fine features combine in an Edinburgh escape
- 71 **OPEN TO CHANGE** In order to afford the Surrey home of her dreams, this owner had to make some clever choices
- 82 **ART & CRAFT** This Dorset detached house has a bright and colourful homespun appeal
- 88 **RESTORING THE PAST** Old and new combine seamlessly in a Kent country house
- 94 **ON THE WATERFRONT** An intriguing mix of furniture and finishes has had a dramatic effect on a luxury lake house in Canada

COVER STORY



Sleek designer touches bring style and sophistication to a listed vicarage in Oxfordshire. (page 26).



REPLANNED

HOME TRUTHS

THE PROPERTY
Detached villa, built in 1853

LOCATION
Southwest London

ROOMS Hall, drawing room, sitting room/kitchen-diner, utility room, cloakroom, five bedrooms (one en suite), two bathrooms

PURCHASED 2014

PREVIOUS PROPERTY
‘We lived in a period house just a couple of miles away,’ says Laura.

Bright OUTLOOK

Laura and Patrick Butler-Madden lovingly turned two flats into a large family home full of light and colour

FEATURE KATHY HURST | PHOTOGRAPHY BRETT CHARLES

KITCHEN-DINER
‘This room is north facing, but the beautiful French windows ensure it’s always flooded with light,’ says Laura. Saarinen round table by Knoll, from £1,716, Skandium. Fritz Hansen Drop chairs in Storm Blue, £250 each, Nest. Beatrice chandelier, £895, Graham and Green



SITTING ROOM

An open-plan layout creates a sociable feel. Long Island corner sofa, from £1,480; Valentin footstool in Amarena Dexter's linen, £410, both Sofa.com. For similar flooring try London White engineered oak, £34.86sq m, Wood and Beyond. Walls painted in Ammonite estate emulsion, £43.50 per 2.5 litres, Farrow & Ball



DRAWING ROOM

Carefully chosen pieces complement the period architecture. For Laura's interior design services, visit laurabuttermadden.com. Lampert sofa, £3,595; Nixon coffee table in marble and polished nickel, £1,950, both Jonathan Adler. Madam Coco side chairs, £835 each, Sofa Workshop. Walls painted in Dimpse estate emulsion, £43.50 per 2.5 litres, Farrow & Ball



HALL

Encaustic patterned tiles make a dramatic statement. 'They're a playful update on Victorian mosaic tiles,' says Laura. Fired Earth Patisserie Sucre 2 floor tiles, £49.75sq m, Tiles-direct.com



When Laura and Patrick Buttermadden stumbled across a leafy

enclave of red brick Victorian villas in their favourite part of south London, they didn't dare imagine that they would one day have a home in this area. 'We were riding around on our scooter and came across a cluster of grand period houses with wide frontages, billowing wisteria and beautiful architectural details,' says Laura, an interior designer and project manager. 'It's a very tranquil area and it felt like stepping back in time.'

The couple put the pipe dream of ever living there to the back of their minds, until an estate agent called a few

weeks later with details of a property that had been converted into two flats. 'Financially, it was well out of reach and the council had not yet granted permission to return it to a single dwelling,' says Laura, 'so it was a bit of a risk. But we offered what we could afford and managed to reach an agreement with the vendor.' Their gamble paid off, and permission to restore the building to a family home came through soon after the sale had been completed.

First, the pair removed the first floor kitchen, stud walls and damaged cornicing, and installed new plumbing and electrics. A single-storey rear extension was added to create a large, open-plan kitchen, and period features such as the



MASTER BEDROOM
An upholstered buttoned bed and matching love seat lend an indulgent feel. Valentin king-size bed, £1,200, Sofa.com. Try Harriet swing-arm wall lamp, £220, Hector Finch

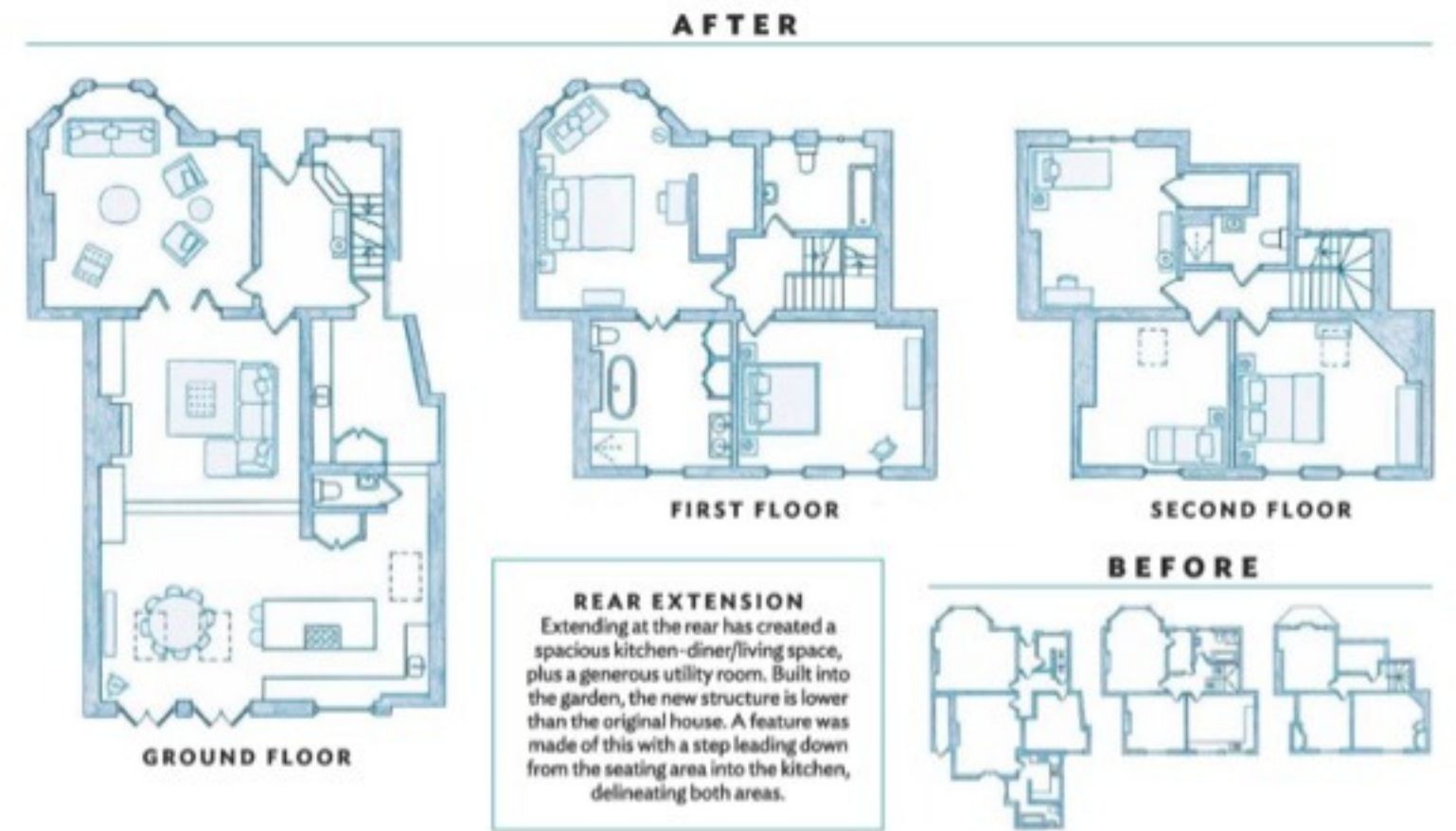

GUEST BEDROOM
'This is a darker colour than I'd normally use,' says Laura. 'The result is lovely and relaxing.' Walls painted in Manor House Gray estate emulsion, £43.50 per 2.5 litres, Farrow & Ball. The Celeste four-poster bed, £499, Maisons du Monde, is similar

cast-iron fireplaces with their ornate mirrored overmantels, were restored. 'We laid smoked white oak chevron flooring throughout the ground floor, which really adds cohesion to the space,' says Laura.

With the shell complete, Laura set to work on the interiors, introducing calm chalky tones for a soothing and elegant look. 'These houses were originally built for wealthy Victorians and I wanted to create a luxurious feel with touches of glamour here and there,' she explains.

In the bathroom, a roll-top bath and bespoke mirrored cabinetry are paired with arresting Arabascato marble tiling. The drawing room features an impressive bay window, and blue velvet and shimmering metallic

furnishings. And a palette of taupes and dusky pinks lends a chic, grown-up feel in the master bedroom. 'I tend to lean towards neutrals and then add touches of colour with either furniture or works of art,' says Laura.

It's the kitchen, however, that has seen the greatest transformation, moving from the first to the ground floor. Light pours through the new skylights, and at the first hint of warmer weather, the French windows are thrown open to let in the sunshine and spring air.

Now the house is finally finished, Laura and Patrick are delighted with their bright, airy slice of London. 'It was a truly serendipitous find,' says Laura. 'We took a chance, it came off and we couldn't be happier.'



EN SUITE
Pale oak flooring gives warmth to this luxurious monochromatic design. Millbrook double-ended bath, £775, Cast Iron Bath Company, is comparable. Glass Orb extra-large chandelier, £750, The White Company